

Base station power cabinet battery setting requirements

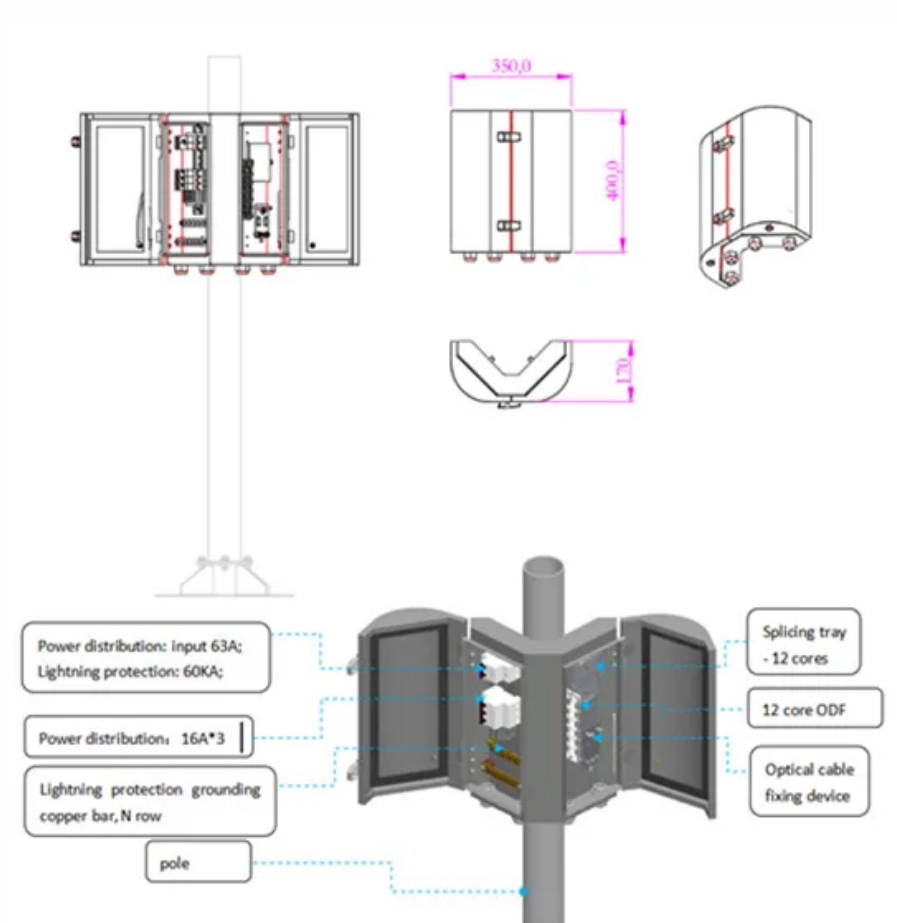

Overview

Must be at least 3 feet apart from each other and any windows, doors, or gas meters. That means, for one battery system, you must have 9 feet of total working space. Should be installed within 20 feet of the. Where can the battery system be installed?

What are the electrical and spacing requirements for Base equipment?

What do I need to know on the day of installation?

Will I need a soft-start on my A/C?

What does that entail?

What safety precautions does Base take?

Safety & Reliability You Can Trust. Each battery occupies a 3ft x 3ft area and is just over 36 inches tall, which is crucial for planning installation space appropriately. The Base installation team tailors configurations to specific site layouts, ensuring efficiency and compliance. Verify that the DC bus voltage is within the normal range and the system is properly grounded. Powered by DaHu SunContainer Page 3/4. This article is a comprehensive, engineering-grade explanation of BESS cabinets: what they are, how they work, what's inside (including HV BOX), how to size them for different applications (not only arbitrage), and how to choose between All-in-One vs battery-only, as well as DC-coupled vs. Minimum clearances must be maintained between the cabinets and surrounding building parts/cabinet to accommodate the installation and maintenance of the base station. The following constraints must be considered for cabinet clearances: In line-ups where battery back-up cabinets may be needed, the. sted to UL 9540. UL 9540 also provides that equipment evaluated to UL 9540A with a written report from a nationally recognized testing laboratory (NRTL), such as ETL, can be permitted to be installed with less than 3ft.

Base station power cabinet battery setting requirements



BESS CABINET

A BESS cabinet is an industrial enclosure that integrates battery energy storage and safety systems, and in many cases includes power conversion and control systems.

[Get Price](#)

Base station battery installation requirements

Battery Installation Requirements in Outdoor Base Stations With the increasing application of outdoor base stations, communication equipment has an obvious demand for battery ...



[Get Price](#)

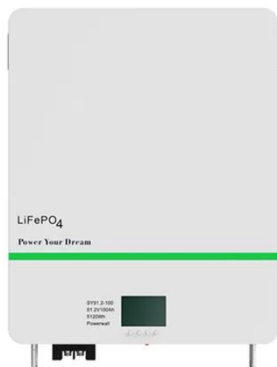

Base station transmission cabinet battery

Among various battery technologies, Lithium Iron Phosphate (LiFePO4) batteries stand out as the ideal choice for telecom base station backup power due to their high safety, long lifespan, and excellent ...

[Get Price](#)

Base station power cabinet battery

settings

This guide covers everything you need to know about how your Base battery operates, protects your home, and supports the power grid. You'll also find answers to common battery myths and top tips to ...

[Get Price](#)



Base station power distribution cabinet configuration requirements

What is a base station power cabinet?The base station power cabinet is a key equipment ensuring continuous power supply to base station devices, with LLVD (Load Low Voltage Disconnect) and ...

[Get Price](#)

Equipment layout and clearances

Clearances This table below lists minimum clearances for indoor primary and power cabinets to an adjacent building or parts/cabinets.

[Get Price](#)



Installation and hardware , Base Help Center

This article explains how you can simulate a power outage and test your Base battery system once your battery is



installed.

[Get Price](#)

EG4 BESS Spacing

The following document clarifies BESS (Battery Energy Storage System) spacing requirements for the EG4 WallMount batteries / rack mount six slot battery cabinet installations.

[Get Price](#)

Lithium Solar Generator: \$150

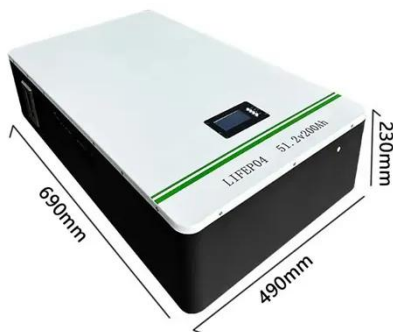

Where can the battery system be installed? What are the electrical ...

Must be at least 3 feet apart from each other and any windows, doors, or gas meters. That means, for one battery system, you must have 9 feet of total working space. For a two battery system, you must ...

[Get Price](#)

NFPA 70E Battery and Battery Room Requirements , NFPA

Its electrical safety requirements, in addition to the rest of NFPA 70E, are for the practical safeguarding of employees

while working with exposed stationary storage batteries that exceed 50 ...

[Get Price](#)



Contact Us

For catalog requests, pricing, or partnerships, please visit:
<https://k3gizycko.pl>

